

The Small Cruise Ship Collection

www.small-cruise-ships.com

small-cruise-ships.com

info@small-cruise-ships.com

SOUTHEAST ALASKA CRUISE

Where Glaciers & Ocean Connect The Awe-Inspiring Gateway to the North Alaska is full of breathtaking scenery, rich history, and epic wildlife. The southeast area of Alaska, also known as 'the Panhandle,' showcases 500 miles of coastline dotted with Sitka spruce and cedar topped off with snowy white mountain peaks, and fjords carved out by prehistoric glaciers.

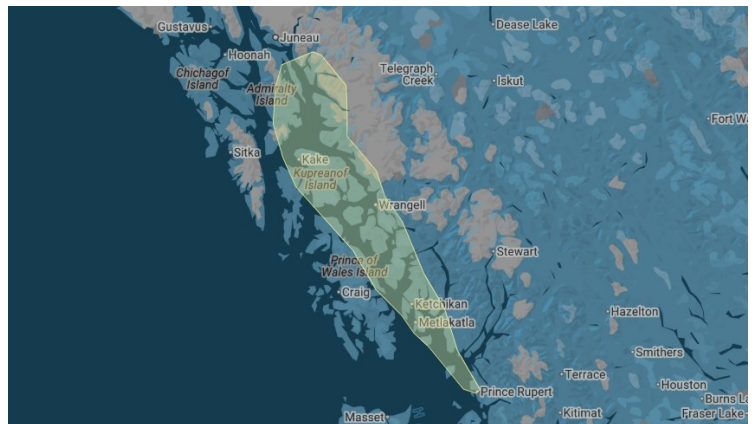

ITINERARY

Trip Start - Day 1 Northern Bound

Meet your Bluewater Adventures crew & vessel late morning at Cow Bay in Prince Rupert. Heading north, we pass through the topography of Chatham Sound and its myriad of islands. The entrance to Portland Canal marks the border between Alaska and British Columbia. Sailing past Misty Fjords National Monument, we enjoy the beautiful scenery of snow-capped mountains rising majestically out of the ocean.

Bluewater Adventures offers two different route options for this itinerary. Please check your trip's dates to confirm your start/end location.

Days 2-4 World Class Bears and Glaciers

We stop briefly to clear US Customs in Ketchikan before continuing north among the narrow passages of Etolin and Wrangell Islands to Anan Bay. Anan Creek has the largest run of

The Small Cruise Ship Collection

www.small-cruise-ships.com

01432 507 280 (within UK)

info@small-cruise-ships.com | small-cruise-ships.com



The Small Cruise Ship Collection

www.small-cruise-ships.com

small-cruise-ships.com

info@small-cruise-ships.com

pink salmon in Southeast Alaska, and this accumulation of food attracts bears and eagles in great numbers. The US Forest Service viewing observatory is famous and access to this area is limited in order to protect the wildlife and local habitat.

We will disembark for a day tour on a jet boat, escorted by a local guide, up to Le Conte Glacier - the southernmost tidewater glacier in Alaska. In the last 15 years, it has receded by over a mile and a half with enormous slabs of ice "calving" into the ocean. It is located beside the Stikine River estuary - an important stop for millions of migratory birds.

Days 5-10 Wildlife of Frederick Sound & Admiralty Island

Frederick Sound, Chatham Strait, and Stephens Passage are the core feeding area for humpback whales in Southeast Alaska. We will take the time to observe these 15-metre-long creatures whenever the opportunity arises and hope to witness spectacular behaviours like breaches, pectoral slaps, and possibly bubble-net feeding (an amazing cooperative foraging technique). We will also keep an eye out for wary sea otters - over 150 years of hunting by Europeans for their luxurious pelts nearly wiped them out completely until the 1960's saw efforts to rebuild the population by reintroducing otters from the Aleutians.

Admiralty Island National Monument has the highest concentration of brown (grizzly) bears in North America. Pack Creek on Admiralty Island has been a protected area for brown bears for the last 40 years and offers amazing viewing opportunities in the estuary of their estimated resident 1,500 bears.

Trip Finish - Day 11 Heading Home

We arrive in Petersburg late in the morning to complete our voyage. After clearing customs, guests can catch an afternoon flight to Seattle or explore the area further on their own.

Please note:

We keep our itineraries purposefully flexible allowing our captains to cater to the needs and interests of their group as well as take into account weather, wildlife sightings, and more.

The Small Cruise
Ship Collection

www.small-cruise-ships.com

01432 507 280 (within UK)

info@small-cruise-ships.com | small-cruise-ships.com



The Small Cruise Ship Collection

www.small-cruise-ships.com



small-cruise-ships.com

info@small-cruise-ships.com

YOUR SHIP: ISLAND ROAMER

YOUR SHIP:	Island Roamer
VESSEL TYPE:	Yacht
LENGTH:	21 metres
PASSENGER CAPACITY:	16
BUILT/REFURBISHED:	1983

The Island Roamer is a custom 68-foot ketch, launched in 1983. The boat's design, safety and comfort make her perfect for these trips. She features 8 private cabins (double occupancy), 3 heads with hot showers, a large comfortable lounge with an extensive library, and a well-equipped galley. On deck, the large covered seating area provides protection in all types of weather. The Island Roamer is large enough for comfort, privacy and safety, and small enough to create a good rapport among passengers and crew.



The Small Cruise Ship Collection

www.small-cruise-ships.com

01432 507 280 (within UK)

info@small-cruise-ships.com | small-cruise-ships.com



The Small Cruise Ship Collection

www.small-cruise-ships.com



small-cruise-ships.com

info@small-cruise-ships.com

INSIDE YOUR SHIP

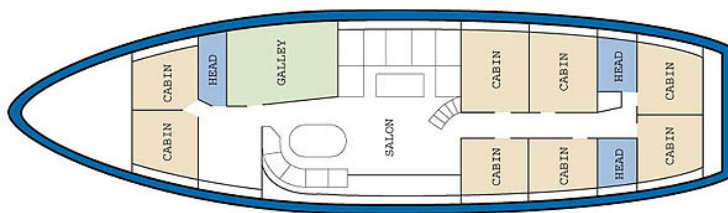

Cabin

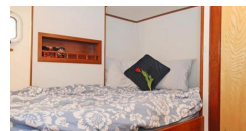

The Small Cruise Ship Collection

www.small-cruise-ships.com

01432 507 280 (within UK)

info@small-cruise-ships.com | small-cruise-ships.com



The Small Cruise Ship Collection

www.small-cruise-ships.com



small-cruise-ships.com

info@small-cruise-ships.com

PRICING

11-Jul-2026 to 21-Jul-2026

Cabin	£6049 GBP pp
-------	--------------

22-Jul-2026 to 01-Aug-2026

Cabin	£6049 GBP pp
-------	--------------

03-Aug-2026 to 13-Aug-2026

Cabin	£6049 GBP pp
-------	--------------

11-Jul-2027 to 21-Jul-2027

Cabin	£5855 GBP pp
-------	--------------

22-Jul-2027 to 01-Aug-2027

Cabin	£5855 GBP pp
-------	--------------

03-Aug-2027 to 13-Aug-2027

Cabin	£5855 GBP pp
-------	--------------

14-Aug-2027 to 24-Aug-2027

Cabin	£5855 GBP pp
-------	--------------

ADDITIONAL CHARGES:

5% Canadian Tax + Sustainability

Fee 200 CAD pp



The Small Cruise Ship Collection

www.small-cruise-ships.com

01432 507 280 (within UK)

info@small-cruise-ships.com | small-cruise-ships.com