

## The Small Cruise Ship Collection

[www.small-cruise-ships.com](http://www.small-cruise-ships.com)

[small-cruise-ships.com](http://small-cruise-ships.com)

[info@small-cruise-ships.com](mailto:info@small-cruise-ships.com)

## KIMBERLEY FISHING EXPEDITION

Offering some of the best fishing in the world, spectacular scenery and perfect weather the Kimberley is undoubtedly a very special place. Isolated and remote, this true wilderness country encompasses rugged gorges, towering sandstone escarpments, meandering river systems and immense estuaries. The waters are teeming with many species of fish including Barramundi, Mangrove Jack, Fingermark Bream, salmon, giant Trevally and more. We take a maximum of 12 guests on our fishing expeditions to ensure that there is plenty of space in our tenders which are driven by a knowledgeable and enthusiastic guide who will use their experience to help you land the 'big ones'!

**KEEN FISHERMEN WANTED** Is there anything better than throwing in a line? Join us for one of our fishing expeditions and you'll get the fishing experience of a lifetime. Our enthusiastic crew have the local knowledge and fishing know-how to help you catch some real beauties. They will show you our secret spots where we work the numerous rock bars, snags and run-offs and fish from dawn till dusk! Our fully-equipped tenders are ideal for a run to where the fish are biting, and with just 12 passengers, there's plenty of room for everyone.

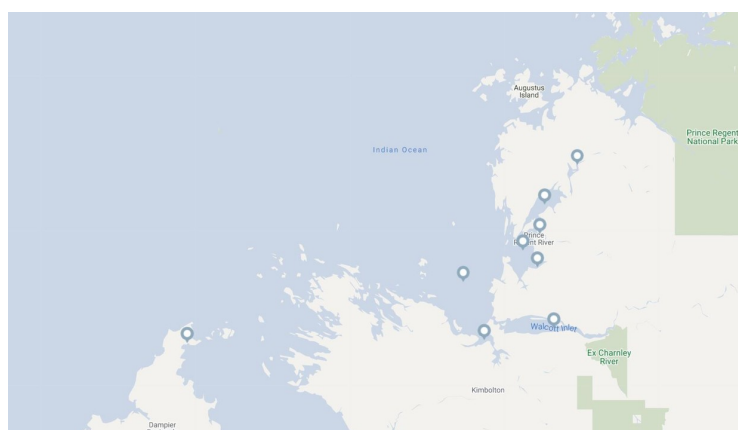

### ITINERARY

#### DAY 1: DEPART BROOME

A courtesy vehicle will pick you up from your accommodation in Broome at approximately 8.00am and transfer you to the Broome airport for a light aircraft flight to join Kimberley Quest II at Cygnet Bay. Your fishing expedition has begun!

#### DAY 2: SECURE BAY

Watch the incredible tidal movements throughout Secure Bay as we cruise through many spectacular whirlpools in search for barramundi. We then head towards the outer islands for your first taste of fishing for Giant Trevally, Spanish Mackerel and other pelagic species.

#### DAY 3: COLLIER BAY / WALCOTT INLET

Another action packed day filled with barramundi fishing! An array of snags, run-offs and rock bars present ideal conditions for big barra and a host of other species which will be lurking in



these waters. See if you can join the metre club!

#### DAY 4: DOUBTFUL BAY

Fish the numerous inlets of Doubtful Bay for the elusive barramundi and Threadfin Salmon. Enjoy a cruise to Red Cone Creek for a refreshing swim at Ruby Falls before trying your luck at mud crabbing.

#### DAY 5 & 6: GEORGE WATER & GLENELG RIVER

We fish the immense estuaries and extensive river systems of the George Water and the Glenelg River, both of which have reputations for 'Big barra'. These two systems are also home to many species of estuary fish including Mangrove Jack, Fingermark and the prized barramundi. No moment is spared without a line in the water! Fish the outgoing tide or try your luck at the numerous creeks, it is serious fishing in these waters!

#### DAY 7: CYGNET BAY - BROOME

After a late breakfast you will disembark the Kimberley Quest II for your light aircraft flight back to Broome. Arrival into Broome will be around midday.

#### Please Note:

All of our specialist Kimberley fishing expeditions are scheduled specifically around the tides to give you maximum fishing time and idyllic conditions. We take a maximum of 12 fishermen to ensure that there is ample space in our four custom-built 5m excursion tenders, all equipped with depth sounders and four-stroke 90HP Honda outboards. All fishing excursions are accompanied by one of our experienced Kimberley fishing guides. We provide a large range of specialist rods and reels, as well as an extensive array of lures. Gear is provided, however you are of course welcome to bring your favourite lures and your

own rod and reel. Heli fishing is available at an additional cost. Note this is to be arranged with the office prior to departure. This is only a suggested itinerary. The remote Kimberley region experiences large tidal movements which can affect our itinerary. We may need to vary this from time to time, however, no matter the tides, we always visit the spectacular icons of this region. There will be plenty of land and sightseeing excursions to many untouched places, and opportunities to catch fresh fish for the table.



# The Small Cruise Ship Collection

[www.small-cruise-ships.com](http://www.small-cruise-ships.com)

[small-cruise-ships.com](http://small-cruise-ships.com)

[info@small-cruise-ships.com](mailto:info@small-cruise-ships.com)

## YOUR SHIP: KIMBERLEY QUEST II

<b>YOUR SHIP:</b>	<b>Kimberley Quest II</b>
<b>VESSEL TYPE:</b>	<b>Luxury Expedition</b>
<b>LENGTH:</b>	<b>24 metres</b>
<b>PASSENGER CAPACITY:</b>	<b>18</b>
<b>BUILT/REFURBISHED:</b>	<b>2005</b>

The Kimberley Quest II has been designed for relaxing and exploring the Kimberley coastline in complete comfort and style. This custom-built vessel is fully air-conditioned, equipped with a helipad, spa, large en-suited cabins and offers indoor and outdoor alfresco areas so there will always be plenty of room to take in the panoramic scenery and breathtaking sunsets. Whilst on board take advantage of the extensive library, including a fantastic array of Kimberley reference books and general interest novels, otherwise sit with the Captain in the wheelhouse and learn more about the Kimberley outback. Accommodating just 18 passengers and 6 crew, your holiday of a lifetime can be enjoyed with fellow travelers in luxurious and intimate surrounds. You have the choice of 9 cabins from deluxe twin, double, superior and the exclusive flybridge. All cabins feature private ensuites, individual air-conditioning, viewing windows, mini-refrigerators and are serviced daily by your hostess. Carrying three excursion tenders, days are filled with a myriad of activities both on and off land, exploring the spectacular region with your very own local guide who has extensive knowledge of the Kimberley coastline. During your cruise you are free to do as much or as little as you wish and can be sure that your

Kimberley Cruise with us will exceed your



expectations!

# The Small Cruise Ship Collection

[www.small-cruise-ships.com](http://www.small-cruise-ships.com)

[small-cruise-ships.com](http://small-cruise-ships.com)

[info@small-cruise-ships.com](mailto:info@small-cruise-ships.com)

## INSIDE YOUR SHIP

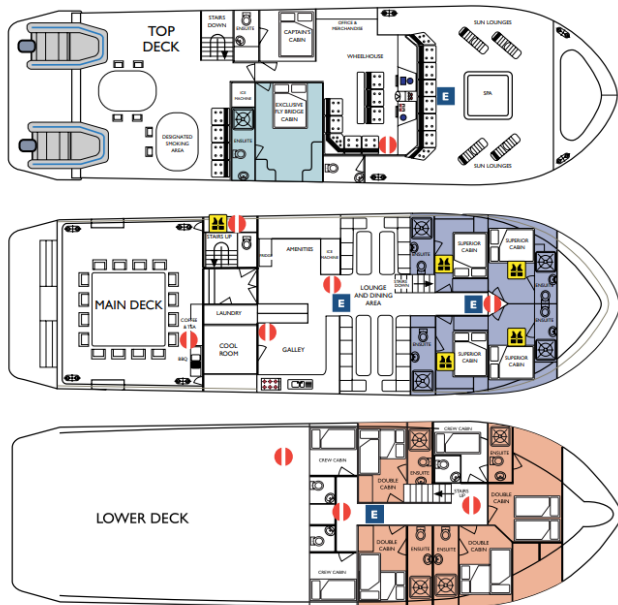

Double Cabin



Flybridge Cabin



Superior Cabin





The Small Cruise  
Ship Collection

[www.small-cruise-ships.com](http://www.small-cruise-ships.com)

[small-cruise-ships.com](http://small-cruise-ships.com)

[info@small-cruise-ships.com](mailto:info@small-cruise-ships.com)

## PRICING

### 16-Oct-2026 to 22-Oct-2026

Double Cabin	£4335 GBP pp
Flybridge Cabin	£5965 GBP pp
Superior Cabin	£5455 GBP pp

### 22-Oct-2026 to 28-Oct-2026

Double Cabin	£4335 GBP pp
Superior Cabin	£5455 GBP pp
Flybridge Cabin	£5965 GBP pp

### 16-Oct-2027 to 22-Oct-2027

Double Cabin	£4409 GBP pp
Superior Cabin	£5529 GBP pp
Flybridge Cabin	£6039 GBP pp

### 22-Oct-2027 to 28-Oct-2027

Double Cabin	£4409 GBP pp
Superior Cabin	£5529 GBP pp
Flybridge Cabin	£6039 GBP pp



The Small Cruise  
Ship Collection

[www.small-cruise-ships.com](http://www.small-cruise-ships.com)

01432 507 280 (within UK)

[info@small-cruise-ships.com](mailto:info@small-cruise-ships.com) | [small-cruise-ships.com](http://small-cruise-ships.com)