



The Small Cruise Ship Collection

www.small-cruise-ships.com



small-cruise-ships.com

info@small-cruise-ships.com

Park information center, the Van Staelen Exhibition Hall, the Breeding and Rearing Center for young tortoises, and adult Galapagos tortoises in captivity.

DAY 2 – SUNDAY AM - Eden Islet & PM - Dragon Hill (Santa Cruz)

El Eden is a paradisiacal tuff cone islet, just off the west coast of Santa Cruz (between Whale Bay and Dragon Hill). This morning we will disembark to the appropriately named Eden Islet. On its coast you will observe land iguanas and sea lions soaking up the sun, as well as seabirds feeding in the nearby mangrove forests. It is a perfect location for swimming activities, as the clear and calm waters will allow you to snorkel along tropical fish, rays, and two species of sharks. Alternatively, a kayak ride would be a memorable experience. PM - Dragon Hill (Santa Cruz) The visitor site at Dragon Hill has been open for visits since 1993. This site is located in northwestern Santa Cruz Island and consists of a trail that leads to a hyper-saline lagoon behind the beach, frequented by flamingos, pintail ducks and other species of birds. This site has been repopulated with land iguanas from Seymour, Isabela and Santa Cruz islands. There is a short walk to the Hill, which offers a beautiful view of the bay.

DAY 3 – MONDAY AM - Whitetip reef shark channel (Isabela) & PM - Wetlands and Wall of Tears (Isabela)

Just outside the port of Puerto Villamil, a group of islets jut out of the ocean. The jagged black formations, dotted with mangroves and candelabra cacti, are the remains of a lava stream that has ended in the ocean. In this place you can easily observe white-tip reef sharks (called "tintorerías", as the official name of the site) from the shore in the crystal clear turquoise waters. Turtles and graceful eagle rays sometimes glide through this calm channel, as do smaller fish and Galapagos sea lions. After this brief visit, you will continue to the upper part of

Isabela. PM - Wetlands and Wall of Tears (Isabela) The Villamil beach wall hides the Las Diablas lagoon; the largest lagoon in the Galapagos and also the breeding place of the largest concentration of red flamingos. It is the jewel of Isabela's swampy wetlands, with more salty and brackish lagoons in collapsed lava tubes, and an ancient mangrove forest. These lagoons attract many wintering waterfowl and shorebirds; some of them even come from arctic regions! Afterwards we will follow a trail to the "The Wall of Tears"; from 1946 to 1959 Isabela was designated a penal colony by the Ecuadorian government. Prisoners were obligated to build a wall with enormous blocks of lava. Due to the arduous labour and harsh conditions in which the prisoners lived, this site is known as "El Muro de las Lagrimas". There are a number of interesting sites along this route, such as the cerro Orchilla, El Estero, Poza Escondida, Playa del Amor and Pozas Verdes. You will certainly be able to see quite a bit of wildlife, including many marine iguanas, a wide variety of birds and, as a highlight, perhaps some giant Galapagos tortoises in the wild.

DAY 4 – TUESDAY AM - Moreno Point (Isabela) & PM - Urbina Bay (Isabela)

Punta Moreno is located on the north coast of Isabela Island between the volcano Sierra Negra and Cerro Azul volcano. The trail runs along a lava flow Pahohoe (solidified lava in the form of corrugated or an accordion) into a complex of coastal lagoons, its main attraction are several species of birds which can be found around these lakes and mangroves. PM - Urbina Bay (Isabela) Urbina Bay is located on the western coast of Isabela, between Elizabeth Bay and Tagus Cove. It is near the base of the Alcedo volcano, so there is a spectacular view. The coastline has suffered a significant uplift, which caused the coastline to expand a little over a kilometer. Here you can find corals, shells



The Small Cruise Ship Collection

www.small-cruise-ships.com

01432 507 280 (within UK)

info@small-cruise-ships.com | small-cruise-ships.com



The Small Cruise Ship Collection

www.small-cruise-ships.com

small-cruise-ships.com

info@small-cruise-ships.com

and many other calcareous organisms exposed out of the water. Urbina Bay is home to large and colorful land iguanas and giant tortoises from the Alcedo Volcano population. You can also see many Darwin's finches, and the wide variety of plants is constantly changing depending on the season.

DAY 5 - WEDNESDAY AM - Espinoza Point (Fernandina) & PM - Tagus Cove (Isabela)

Fernandina is the third largest island in the archipelago and has a single visitor site: Punta Espinoza located at the northeastern tip of the island. Marine iguanas conglomerate in larger groups than in any other island. They bask around in the sand, swim near the shore and sometime block the way at the landing dock. Among the unique species found here, is the Flightless Cormorant. This bird had to adjust its way of survival and perfection its skills of finding food in the ocean. Their wings, tails and feet progressively adapted for swimming. To see these birds, is to witness evolution happening right in front of you. PM - Tagus Cove (Isabela) A tour along the cliffs in a zodiac will give the visitors a good chance to see the Galapagos penguin, the flightless cormorant and other sea birds. From the landing dock it is about a 30 minute hike along the trail up to the top of the cliff from where you can view Darwin Lake, an uplifted ultra-saline lake saltier than the sea. You can also see several volcanoes from this location. Look carefully at the graffiti on the surrounding cliffs of the cove, it has been written by pirates, whalers and buccaneers in past centuries.

DAY 6 - THURSDAY AM - Puerto Egas (Santiago) & PM - Rabida

Puerto Egas is a black beach is located at the west side of Santiago Island. Volcanic tuff deposits have favored the formation of this special black sand beach and this is the main attraction of the Island. This site is called Puerto Egas, because

there was an attempt of company of Hector Egas, to start the exploitation of salt, which failed because the price of salt on the continent was very cheap, and did not justify its exploitation in Galapagos. The project was abandoned and they left their infrastructure. PM - Rabida After a wet landing on the remarkable red beach of Rabida, there are two short guided walks. Iron oxide particles give rocks and sand their reddish color. The beach wall has a shallow lagoon fringed with green; This oasis is the most fertile spot on the otherwise barren islet, which is covered in palo santo trees. The salty lagoon attracts all kinds of waterfowl, including pintails and sometimes red flamingos. Many species of songbirds hide and breed among the evergreen foliage of the surrounding mangroves. One of the most outstanding attractions is the important breeding colony of brown pelicans, the only pelicans in the world that dive.

DAY 7 - FRIDAY AM - Las Bachas Beach (Santa Cruz)

These two small beaches are located to the west of Black Turtle Cove, in Santa Cruz. Its sand consists of decomposed corals, which makes it white and soft. This makes it a favorite nesting site for sea turtles. Behind one of the beaches there are small lagoons, where flamingos and other shore birds, such as Galapagos gulls and lapwings, can be seen from time to time. On the second beach, which is the widest, you can explore the remains of two abandoned warships. In World War II, these were left behind by the US, as the island of Baltra was used as a strategic point for the protection of the Panama Canal. The name Las Bachas originated at this time, since the word with which the North Americans called these two boats, "barges", was difficult for the local inhabitants to pronounce and they ended up making it Spanish. Transfer out to Baltra Airport (GPS) Transfer to Baltra Airport (GPS) for your flight back to Guayaquil or Quito.



01432 507 280 (within UK)

info@small-cruise-ships.com | small-cruise-ships.com



The Small Cruise Ship Collection

www.small-cruise-ships.com



small-cruise-ships.com

info@small-cruise-ships.com

Please Note:

Itineraries are subject to change.



The Small Cruise Ship Collection

www.small-cruise-ships.com

01432 507 280 (within UK)

info@small-cruise-ships.com | small-cruise-ships.com



The Small Cruise
Ship Collection

www.small-cruise-ships.com



small-cruise-ships.com

info@small-cruise-ships.com

YOUR SHIP: TREASURE OF GALAPAGOS

YOUR SHIP:

Treasure of Galapagos

and snorkel).

VESSEL TYPE:

LENGTH:

PASSENGER CAPACITY:

BUILT/REFURBISHED:

Treasure of Galapagos has just 9 cabins, all with balconies, and is designed specifically for cruising the Galapagos Islands. Treasure is a stable & wide motor catamaran with the comfort of a floating hotel. All cabins are spacious & bright and have a private balcony & sea view. Treasure was launched in 2009 and completely refurbished in 2024. **CABIN DISTRIBUTION** Main Deck: 3 twin suites, 1 double suite and 1 master suite (optionally convertible into a family suite for 4 people) Upper Deck: 2 twin suites & 2 double suites. Staterooms: 20m² (8) main & upper Family suite maindeck: 40m² (1) **SOCIAL AREAS & AMENITIES** Sun deck: Solarium area, shaded resting area & whirlpool. Upper deck: Shaded terrace & al fresco dining Main deck: Air-conditioned lounge with living room, dining room, and bar. Amenities: Outdoor whirlpool for up to 4 people (with Jacuzzi ® jets); deck chairs, BBQ, TV/DVD, small library, board games **INCLUSIONS** Lodging on board in a cabin with private facilities All meals, water, coffee and tea All excursions as mentioned in the itinerary (itinerary subject to change) with English speaking naturalist guide. All transfers in Galapagos (airport-yacht-airport transfers are only guaranteed if the flight has been booked through us) Snorkeling gear (masks, flippers



The Small Cruise
Ship Collection

www.small-cruise-ships.com

01432 507 280 (within UK)

info@small-cruise-ships.com | small-cruise-ships.com



The Small Cruise Ship Collection

www.small-cruise-ships.com



small-cruise-ships.com

info@small-cruise-ships.com

INSIDE YOUR SHIP

Main Deck

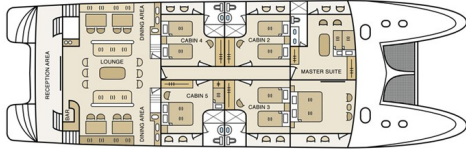

Upper Deck

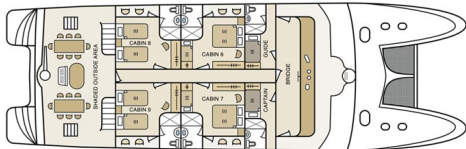

Sun Deck

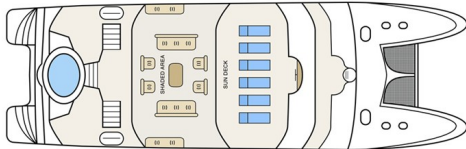



The Small Cruise Ship Collection

www.small-cruise-ships.com



small-cruise-ships.com

info@small-cruise-ships.com

PRICING

18-Apr-2026 to 24-Apr-2026

Cabin £4775 GBP pp

02-May-2026 to 08-May-2026

Cabin £4775 GBP pp

16-May-2026 to 22-May-2026

Cabin £4775 GBP pp

30-May-2026 to 05-Jun-2026

Cabin £4775 GBP pp

13-Jun-2026 to 19-Jun-2026

Cabin £4775 GBP pp

27-Jun-2026 to 03-Jul-2026

Cabin £4775 GBP pp

11-Jul-2026 to 17-Jul-2026

Cabin £4775 GBP pp

25-Jul-2026 to 31-Jul-2026

Cabin £4775 GBP pp

19-Sep-2026 to 25-Sep-2026

Cabin £4775 GBP pp

03-Oct-2026 to 09-Oct-2026

Cabin £4775 GBP pp

17-Oct-2026 to 23-Oct-2026

Cabin £4775 GBP pp

31-Oct-2026 to 06-Nov-2026

Cabin £4775 GBP pp

14-Nov-2026 to 20-Nov-2026

Cabin £4775 GBP pp

28-Nov-2026 to 04-Dec-2026

Cabin £4775 GBP pp

12-Dec-2026 to 18-Dec-2026

Cabin £4775 GBP pp

26-Dec-2026 to 01-Jan-2027

Cabin £4775 GBP pp

09-Jan-2027 to 15-Jan-2027

Cabin £5005 GBP pp

23-Jan-2027 to 29-Jan-2027

Cabin £5005 GBP pp

06-Feb-2027 to 12-Feb-2027

Cabin £5005 GBP pp

20-Feb-2027 to 26-Feb-2027

Cabin £5005 GBP pp

06-Mar-2027 to 12-Mar-2027

Cabin £5005 GBP pp

20-Mar-2027 to 26-Mar-2027

Cabin £5005 GBP pp



01432 507 280 (within UK)

info@small-cruise-ships.com | small-cruise-ships.com



The Small Cruise Ship Collection

www.small-cruise-ships.com



small-cruise-ships.com

info@small-cruise-ships.com

03-Apr-2027 to 09-Apr-2027

Cabin £5005 GBP pp

17-Apr-2027 to 23-Apr-2027

Cabin £5005 GBP pp

01-May-2027 to 07-May-2027

Cabin £5005 GBP pp

15-May-2027 to 21-May-2027

Cabin £5005 GBP pp

29-May-2027 to 04-Jun-2027

Cabin £5005 GBP pp

12-Jun-2027 to 18-Jun-2027

Cabin £5005 GBP pp

26-Jun-2027 to 02-Jul-2027

Cabin £5005 GBP pp

10-Jul-2027 to 16-Jul-2027

Cabin £5005 GBP pp

24-Jul-2027 to 30-Jul-2027

Cabin £5005 GBP pp

07-Aug-2027 to 13-Aug-2027

Cabin £5005 GBP pp

21-Aug-2027 to 27-Aug-2027

Cabin £5005 GBP pp

04-Sep-2027 to 10-Sep-2027

Cabin £5005 GBP pp

18-Sep-2027 to 24-Sep-2027

Cabin £5005 GBP pp

02-Oct-2027 to 08-Oct-2027

Cabin £5005 GBP pp



www.small-cruise-ships.com

01432 507 280 (within UK)

info@small-cruise-ships.com | small-cruise-ships.com



The Small Cruise Ship Collection

www.small-cruise-ships.com



small-cruise-ships.com

info@small-cruise-ships.com

PRICING

16-Oct-2027 to 22-Oct-2027

Cabin	£5005 GBP pp
-------	--------------

30-Oct-2027 to 05-Nov-2027

Cabin	£5005 GBP pp
-------	--------------

13-Nov-2027 to 19-Nov-2027

Cabin	£5005 GBP pp
-------	--------------

27-Nov-2027 to 03-Dec-2027

Cabin	£5005 GBP pp
-------	--------------

11-Dec-2027 to 17-Dec-2027

Cabin	£5005 GBP pp
-------	--------------

25-Dec-2027 to 31-Dec-2027

Cabin	£5005 GBP pp
-------	--------------



The Small Cruise Ship Collection

www.small-cruise-ships.com

01432 507 280 (within UK)

info@small-cruise-ships.com | small-cruise-ships.com