





## The Small Cruise Ship Collection

[www.small-cruise-ships.com](http://www.small-cruise-ships.com)



[small-cruise-ships.com](http://small-cruise-ships.com)

[info@small-cruise-ships.com](mailto:info@small-cruise-ships.com)

backs. After sharing the company of these modern-day dinosaurs in their natural habitat, you will return on board for dinner, entertainment, and relaxation.

### DAY 2 - SATURDAY AM - Sullivan Bay (Santiago) & PM - Bartholomew

The arrival in Sullivan Bay is like a moon landing. The desolate, sprawling fields seem to be mostly lifeless, but this island, which is particularly popular among photographers, still offers a lot to see. There is even some life! Green sea turtles burrow in the small white sand beach, where you can also find crabs, blue herons and oystercatchers. In the lava flow, only sparse pioneer vegetation, such as lava cacti and molluscs, can grow. PM - Bartholomew The island of Bartholomew rises 114m above Sullivan Bay. Climb the steps of the Bartolomé Peak Trail and you will be rewarded with panoramic views over volcanic peaks, lunar craters and lava fields. Afterwards you can refresh yourself at the foot of the famous "Pinnacle Rock" and explore the underwater world in the shallow water while snorkelling. Although there is little vegetation on this island, it has two breathtaking beaches, where sea turtles live. At the foot of the mountain you can also discover a small colony of Galapagos penguins.

### DAY 3 - SUNDAY AM - North Seymour & PM - South Plaza

Seymour is an uplifted (as opposed to volcanic) island and therefore is generally flat and strewn with boulders. There are good nesting sites here for a large population of magnificent frigate birds. Blue-footed boobies perform their courtship dance in the more open areas and swallow-tailed gulls perch on the cliff edges. Despite the tremendous surf that can pound the outer shore, sea lions haul out onto the beach and can be found bodysurfing. Do watch your step as the boobies don't worry much about where they nest, and you might just step on one.

The trees are dotted with male frigate birds trying to attract the attention of the ladies by inflating their bright red skin flaps. They sometimes fly in the air to call more attention to themselves. There's a circular path that takes you through the island to a beautiful, rocky shore where the waves crash a silvery-blue. PM - South Plaza This afternoon's excursion will be on the South Plaza Islet. While landing there, a barking Galapagos sea lion bull may block the jetty for a loud welcome to his beach and rookery. Overall, this islet breathes a unique Jurassic ambiance, with its psychedelic reddish flora and giant Opuntia cacti covering the landscape and providing food and shelter for thousands of endemic marine and Barrington iguanas. During this visit, you will also have the opportunity to swim over a reef of boulders that attracts an amazing variety of marine life, such as sea turtles, reef sharks, stingrays, and sea lions.

### DAY 4 - MONDAY AM - Pitt Islet and Pitt Point (San Cristobal) & PM - Witch Hill (San Cristobal)

The wind-sculpted cliffs of Pitt Point were the first sight of land when Charles Darwin arrived in the Galapagos aboard the HMS Beagle on September 15, 1835. Today you will disembark to that very same small green sand beach, where you will first be greeted by a group of barking sea lions. Behind this dreamy beach, crossing some thorny bushes, begins a trail that will take you to the top of the cliff through a ravine. While you ascend, marvel at the landscapes of this geological wonder, where its possible to find three species of boobies breeding and playing: blue-footed, red-footed and Nazca. Two species of frigate birds can be found as well (Great and Magnificent) Do not miss the chance to snorkel or kayak around these far-away, dreamlike shores. PM - Witch Hill (San Cristobal) Witch Hill (Cerro Brujo in Spanish) is the remains of a tuff cone, and its primary attraction



01432 507 280 (within UK)

[info@small-cruise-ships.com](mailto:info@small-cruise-ships.com) | [small-cruise-ships.com](http://small-cruise-ships.com)





is a coral sand beach that opens into a tranquil bay. Snorkeling here leads to a rich habitat for marine iguanas, stingrays, white-tipped sharks, eagle rays, turtles, morays, garden eels, and many kinds of reef fishes. Behind the sand dunes of the beach, there is a dry dark lava flow with salty ponds, which serve as a refreshment spot for iguanas, as well as a strategic place to observe coastal and migratory birds, including pelicans, blue-footed boobies, and swallow-tailed gulls.

**DAY 5 - TUESDAY AM - Interpretation Center (San Cristobal)**

The Galapagos National Park Visitor Center lies close to the port town of Puerto Baquerizo Moreno. The center explains a series of natural circumstances such as the volcanic origins of the islands, their remoteness from the continent, its ocean currents, its special climate, the arrival of different species, and their establishment, among others. Transfer to San Cristobal airport It has been a pleasure accompanying you on this unique trip and we hope to see you again very soon!

**Please Note:**

Itineraries are subject to change.



The Small Cruise  
Ship Collection

[www.small-cruise-ships.com](http://www.small-cruise-ships.com)



[small-cruise-ships.com](http://small-cruise-ships.com)

[info@small-cruise-ships.com](mailto:info@small-cruise-ships.com)

## YOUR SHIP: TREASURE OF GALAPAGOS

**YOUR SHIP:**

**Treasure of Galapagos**

and snorkel).

**VESSEL TYPE:**

**LENGTH:**

**PASSENGER CAPACITY:**

**BUILT/REFURBISHED:**

Treasure of Galapagos has just 9 cabins, all with balconies, and is designed specifically for cruising the Galapagos Islands. Treasure is a stable & wide motor catamaran with the comfort of a floating hotel. All cabins are spacious & bright and have a private balcony & sea view. Treasure was launched in 2009 and completely refurbished in 2024. **CABIN DISTRIBUTION** Main Deck: 3 twin suites, 1 double suite and 1 master suite (optionally convertible into a family suite for 4 people) Upper Deck: 2 twin suites & 2 double suites. Staterooms: 20m<sup>2</sup> (8) main & upper Family suite maindeck: 40m<sup>2</sup> (1) **SOCIAL AREAS & AMENITIES** Sun deck: Solarium area, shaded resting area & whirlpool. Upper deck: Shaded terrace & al fresco dining Main deck: Air-conditioned lounge with living room, dining room, and bar. Amenities: Outdoor whirlpool for up to 4 people (with Jacuzzi ® jets); deck chairs, BBQ, TV/DVD, small library, board games **INCLUSIONS** Lodging on board in a cabin with private facilities All meals, water, coffee and tea All excursions as mentioned in the itinerary (itinerary subject to change) with English speaking naturalist guide. All transfers in Galapagos (airport-yacht-airport transfers are only guaranteed if the flight has been booked through us) Snorkeling gear (masks, flippers



The Small Cruise  
Ship Collection

[www.small-cruise-ships.com](http://www.small-cruise-ships.com)

**01432 507 280** (within UK)

[info@small-cruise-ships.com](mailto:info@small-cruise-ships.com) | [small-cruise-ships.com](http://small-cruise-ships.com)





# The Small Cruise Ship Collection

[www.small-cruise-ships.com](http://www.small-cruise-ships.com)



[small-cruise-ships.com](http://small-cruise-ships.com)

[info@small-cruise-ships.com](mailto:info@small-cruise-ships.com)

## INSIDE YOUR SHIP

Main Deck

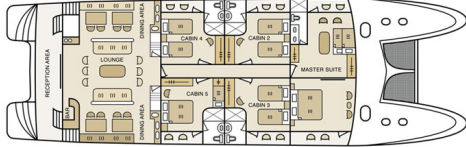

Upper Deck

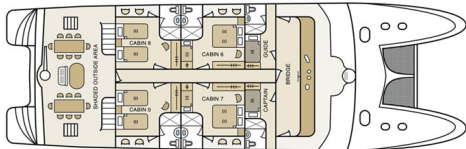

Sun Deck

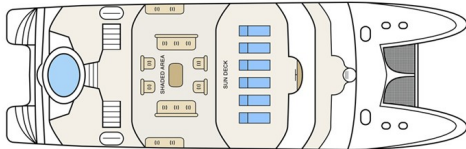

Cabin





# The Small Cruise Ship Collection

[www.small-cruise-ships.com](http://www.small-cruise-ships.com)



[small-cruise-ships.com](http://small-cruise-ships.com)

[info@small-cruise-ships.com](mailto:info@small-cruise-ships.com)

## PRICING

### 19-Dec-2025 to 23-Dec-2025

Cabin	£3022 GBP pp
-------	--------------

### 16-Jan-2026 to 20-Jan-2026

Cabin	£3118 GBP pp
-------	--------------

### 30-Jan-2026 to 03-Feb-2026

Cabin	£3118 GBP pp
-------	--------------

### 13-Feb-2026 to 17-Feb-2026

Cabin	£3118 GBP pp
-------	--------------

### 27-Feb-2026 to 03-Mar-2026

Cabin	£3118 GBP pp
-------	--------------