

# The Small Cruise Ship Collection

www.small-cruise-ships.com

small-cruise-ships.com

info@small-cruise-ships.com

## DUBROVNIK TO SPLIT LUXURY CRUISE IN SEPTEMBER

After a tour of Dubrovnik we will cruise to Mljet National Park, a monastery on an island, on a lake, on an island. Mljet is a beautiful spot to walk, cycle, swim, kayak or take a small boat across the lake to visit the monastery. After an evening out at one of the lovely restaurants in Korčula (birthplace of Marco Polo) we head to the lovely island and port of Vis, hoping the weather is good enough to allow us to visit the Blue Cave. We finish with visits to Hvar, one of the trendiest towns in Croatia, historic Trogir and the buzzing and beautiful city of Split, a UNESCO World Heritage site. Interspersed with the stops in the beautiful ports and towns we moor overnight in, we will have a swim stop every day in a secluded bay, and the chance to eat ashore in the evenings at one of the many fine restaurants and cafes that line these historic ports. We only cruise for 4-5 hours a day, just time to enjoy a coffee and a few pages of a book if you can peel your eyes away from the scenery.



### ITINERARY

#### Day 1 Dubrovnik

Embarkation begins at 14:00h. Get settled in your cabin before attending a Welcome Reception followed by dinner this evening. Overnight in Dubrovnik. (D)

#### Day 2. Dubrovnik – Šipan island or Slano

This morning, after breakfast, you will take a coach transfer to the Old town and in company of our licenced guide and you will have the opportunity to explore Dubrovnik, Pearl of the Adriatic, UNESCO's World Heritage site since 1979. After a guided city tour, you will have free time to explore at your own pace the rich history of the Old town or visit some of the famous sights of the "Pearl of Adriatic", like Cable car ride to Sr Mountain or a stroll along the City walls.

A return coach transfer to the port of Gruž will be organized for you at the scheduled time. Upon return to the port, we leave Dubrovnik and head to the Island of Šipan and its peaceful

The Small Cruise Ship Collection

www.small-cruise-ships.com

01432 507 280 (within UK)

info@small-cruise-ships.com | small-cruise-ships.com



## The Small Cruise Ship Collection

[www.small-cruise-ships.com](http://www.small-cruise-ships.com)

[small-cruise-ships.com](http://small-cruise-ships.com)

[info@small-cruise-ships.com](mailto:info@small-cruise-ships.com)

fishermen's village, Šipanska Luka. Lunch on board. In case we are not able to anchor there because of weather conditions or docking capacity limits, we will cruise to Slano, situated in a mainland. This evening is reserved for nice time on board where you will enjoy in Captain's dinner. Overnight in Šipanska Luka or in Slano. (B, L, CD)

### Day 3 Šipan island or Slano – Mljet National park – Kor ula

Morning departure and cruise towards the island of Mljet. Upon arrival, you will visit the National Park, well known for its versatile eco-system and two salt lakes ("Veliko jezero" - Big Lake and "Malo jezero" - Small Lake), as well as for Benedictine Monastery from 12th century located on the St Mary's Islet. After relaxing stroll in the park and around its lakes, you'll return to the boat where your lunch will be served.

We leave Pomena at lunch-time and cruise to the Island of Kor ula. City of Kor ula is one of the best-preserved medieval cities in the Mediterranean, thought to be the birthplace of the famous explorer Marco Polo. After arriving in Kor ula in the afternoon, you will join our guide for a walking tour of Kor ula. After the walking tour, enjoy your free evening to try out some homemade food in one of many restaurants. Overnight in Kor ula. (B, L)

### Tuesday: Kor ula – Vis

We leave Kor ula in the morning and cruise towards the island of Vis. Lunch will be served on board and we'll make some swim stops along the sail. We arrive in Vis in the afternoon. Vis is a small town on an island well known for its strategic importance through the years. You will have free time to explore Vis at your own pace. Being closed during the time of ex-Yugoslavia, this wonderful island is still like an unspoiled and preserved oasis.

Depending on the capacity of Vis port and possibility of docking, the visit to the town of Vis can be replaced by docking in Komiža, beautiful quaint fisherman village. Overnight in Vis or Komiža. (B, L)

### Day 5 Vis – Biševo Blue Cave – Hvar

In the morning, we set sail again, this time towards the island of Biševo and its famous Blue Cave. This mesmerizing natural attraction is breath-taking with its game of sunlight which creates a wonderful reflection from its white floor and bathes the cave in aquamarine light. Blue Cave can only be approached by boat and sometimes it can happen that due to winds, waves and currents, the access to the cave is not possible. We can only know about the sea conditions and possibility of entrance on the exact same morning of the visit. After a relaxing swim stop and lunch, we continue our navigation towards the Island of Hvar. Upon arrival in Hvar, join our guided city tour, find out about its rich history and beautiful architecture and important landmarks like Cathedral of St Stephen, the Theatre which is one of the oldest in Europe dating back from 1612, Spanish Fortress, ... Later on, you can explore the town on your own and check what its night life has to offer. Overnight in Hvar. (B, L)

### Day 6 Hvar – Milna (island of Bra )

In the morning, we leave Hvar and head to our next stop, Milna. Lunch on board and swim stop during the sail. Milna is a charming coastal village on the island of Bra , known for its peaceful atmosphere, crystal-clear waters, and beautiful stone houses. Its sheltered harbour and scenic surroundings make it a perfect spot to relax and enjoy authentic Dalmatian charm. Overnight in Milna (B, L)

### Day 7 Milna - Trogir

The Small Cruise Ship Collection

[www.small-cruise-ships.com](http://www.small-cruise-ships.com)

01432 507 280 (within UK)

[info@small-cruise-ships.com](mailto:info@small-cruise-ships.com) | [small-cruise-ships.com](http://small-cruise-ships.com)



The Small Cruise  
Ship Collection

[www.small-cruise-ships.com](http://www.small-cruise-ships.com)

[small-cruise-ships.com](http://small-cruise-ships.com)

[info@small-cruise-ships.com](mailto:info@small-cruise-ships.com)

On the last day of our navigation, we set sails towards our last stop, city of Trogir, another Unesco world heritage site. Lunch on board. We arrive in Trogir in the afternoon. You will join our guide for a walking tour of Trogir whose rich history influenced by many people (Greeks, Romans, Venetians) is visible on every single step of its beautiful, narrow, cobbled streets. You will admire the architecture of Trogir's most imposing monument, the Cathedral of St Lawrence, built in Romanesque-Gothic style. After the city tour, you will have free time to explore Trogir at your own pace. Overnight in Trogir. (B, L)

Day 8 Trogir

After breakfast, it's time to disembark. (B)

# The Small Cruise Ship Collection

[www.small-cruise-ships.com](http://www.small-cruise-ships.com)

[small-cruise-ships.com](http://small-cruise-ships.com)

[info@small-cruise-ships.com](mailto:info@small-cruise-ships.com)

## YOUR SHIP: ADRIATIC QUEEN(CATAMARAN)

|                            |                                  |
|----------------------------|----------------------------------|
| <b>YOUR SHIP:</b>          | <b>Adriatic Queen(Catamaran)</b> |
| <b>VESSEL TYPE:</b>        | <b>Small Ship</b>                |
| <b>LENGTH:</b>             | <b>35 meters</b>                 |
| <b>PASSENGER CAPACITY:</b> | <b>30</b>                        |
| <b>BUILT/REFURBISHED:</b>  |                                  |



This luxurious vessel was completely renovated in 2017 with latest state-of-the-art equipment and amenities. It is 115 ft long, 36 ft wide, with cruising speed of 10 NM. Maximum capacity is 30 passengers in 15 cabins, all on one deck, all fully air-conditioned, with queen-size (7) or twin beds (8), cupboard, cabinet and window or porthole, bathroom with shower, toilette and wash basin. Cabin size varies between 140 sq ft and 172 sq ft. There is free wireless internet access (Wi-Fi). The ship features fully air-conditioned salon-restaurant with bar and LCD TV. Large lounging sun deck has a jacuzzi fitting up to 6 people, and provides sun-shade cover and deck-beds for all passengers. The ship has a rear access platform to the sea as well as ladders for easy access to the water. Ship Amenities: Sun deck, restaurant & bar, complimentary Wi-Fi Cabins include: LCD TV, A/C, safe deposit box, fridge, sound-proofing, internal communication system with bar

The Small Cruise Ship Collection

[www.small-cruise-ships.com](http://www.small-cruise-ships.com)

01432 507 280 (within UK)

[info@small-cruise-ships.com](mailto:info@small-cruise-ships.com) | [small-cruise-ships.com](http://small-cruise-ships.com)

# The Small Cruise Ship Collection

[www.small-cruise-ships.com](http://www.small-cruise-ships.com)

[small-cruise-ships.com](http://small-cruise-ships.com)

[info@small-cruise-ships.com](mailto:info@small-cruise-ships.com)

## INSIDE YOUR SHIP

SUN DECK

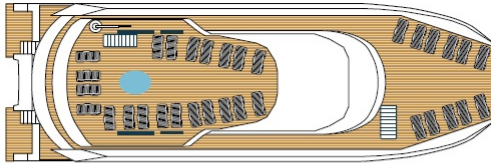

BRIDGE DECK

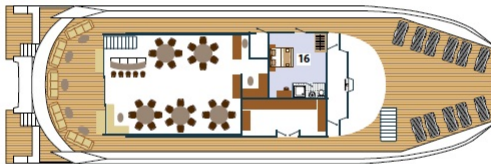

MAIN DECK



Lower deck cabin



Main deck



Main deck cabin





# The Small Cruise Ship Collection

[www.small-cruise-ships.com](http://www.small-cruise-ships.com)

[small-cruise-ships.com](http://small-cruise-ships.com)

[info@small-cruise-ships.com](mailto:info@small-cruise-ships.com)

## PRICING

### 06-Sep-2026 to 13-Sep-2026

|                  |              |
|------------------|--------------|
| Lower deck cabin | £2299 GBP pp |
|------------------|--------------|

|                 |              |
|-----------------|--------------|
| Main deck cabin | £2499 GBP pp |
|-----------------|--------------|

### 13-Sep-2026 to 20-Sep-2026

|           |              |
|-----------|--------------|
| Main deck | £1999 GBP pp |
|-----------|--------------|

**ADDITIONAL CHARGES:** Port Fees 60 EUR pp